

TERMINATION, FLANGE MOUNT CVD DIAMOND 50 WATT, DC TO 20 GHz

DATASHEET PART SERIES: CT0505DHT

Sheet 1 of 2
Doc# CT0505DHT-1013165ECO-082846
Revision B

ORDERING INFORMATION

PART IDENTIFIER: CT0505DHT

SPECIFICATIONS

1.0 ELECTRICAL

Nominal Impedance:	50 Ω
Frequency Range:	DC - 20 GHz
Input Power CW:	50 Watts
Peak Power:	500 Watts (1 μ s pulse width, 1% duty cycle)
VSWR:	1.5:1 Max

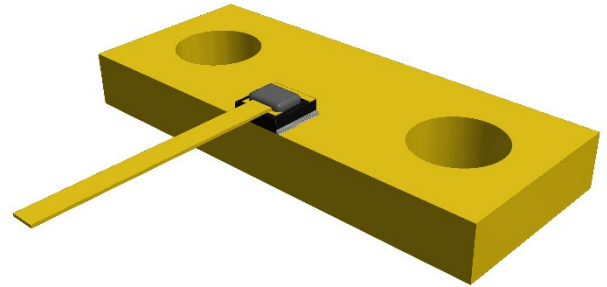

2.0 ENVIRONMENTAL

Operating Temperature:	-55°C to +125°C
Non-operating Temperature:	-55°C to +150°C
Temperature Coefficient:	\pm 200 PPM/°C Max

3.0 MARKING

Unit Marking:	None
---------------	------

4.0 QUALITY ASSURANCE

Sample Inspect Per MIL-STD-105, Level II, 1.0% AQL.
 Visual and Mechanical Inspection for Conformance to Outline Drawing
 Measure DC Resistance
 Data Retention - Standard

5.0 PACKAGING

Standard:	Tray Packaging
-----------	----------------

6.0 MECHANICAL

Substrate Material:	CVD Diamond
Resistive Element:	Passivated TaN
Metallization:	Gold over Nickel
Flange:	Copper, Gold Plated
Tab:	Copper, Gold Plated
Metric Dimensions:	Provided for reference only

TERMINATION, FLANGE MOUNT CVD DIAMOND 50 WATT, DC TO 20 GHz

DATASHEET PART SERIES: CT0505DHT

Sheet 2 of 2
Doc# CT0505DHT-1013165

ECO-082846
Revision B

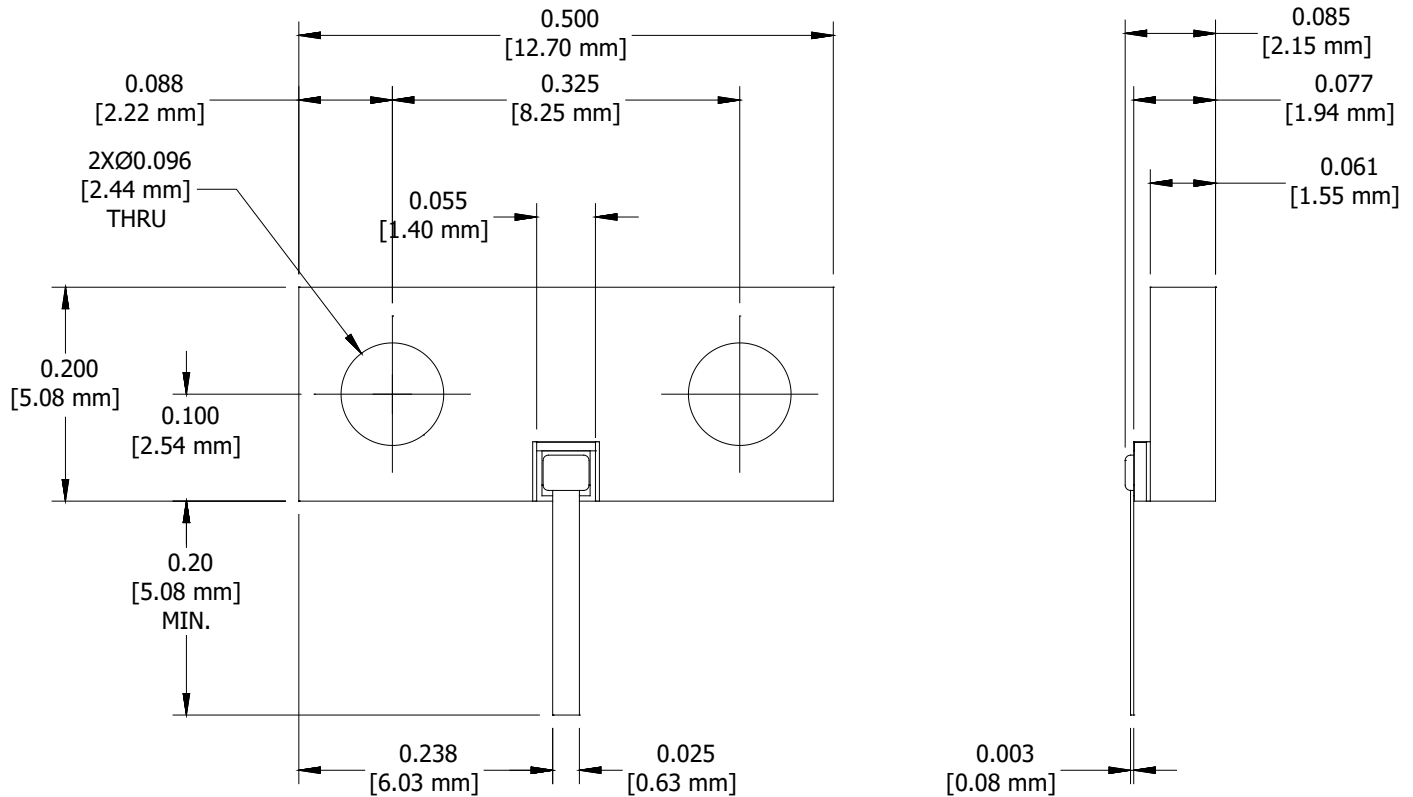
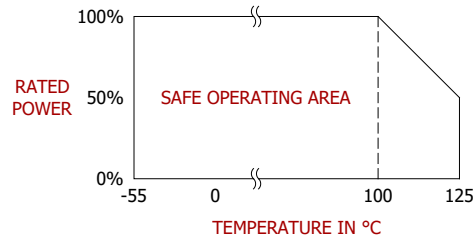

Unless Otherwise Specified: TOLERANCE: X.XX = ± 0.02 X.XXX = ± 0.010