

FEATURES

- Tab Launch
- High Power
- Low VSWR
- Integrated Heat Sink

APPLICATIONS

- Telecom Base Stations
- Broadcast
- High Power Filters
- High Power Amplifiers
- Instrumentation

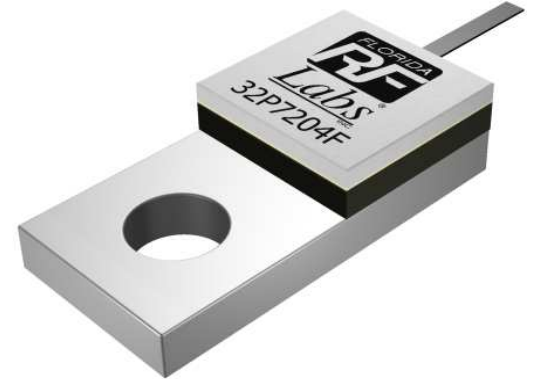

GENERAL DESCRIPTION

Florida RF Labs offers the widest selection of flange mount terminations worldwide. High power flange mount components offer excellent performance and the convenience of bolt-in installation. The flanged mounted devices deliver power ratings up to 1000 watts and frequency ranges from DC to 18 GHz. The packages are available in single hole, double hole and four hole flange configurations. This series of products is specifically designed for high power "Low PIM" applications.

SPECIFICATIONS

1.0 ELECTRICAL

Nominal Impedance:	50 Ω
Frequency Range:	DC – 4.0 GHz
VSWR:	1.08:1 DC - 2.0 GHz Max 1.20:1 2.0 - 4.0 GHz Max
Temperature Coefficient:	± 200 PPM/ $^{\circ}$ C Max
Power Rating:	100 Watts
Operating Temperature:	-55 $^{\circ}$ C To +150 $^{\circ}$ C
DC Resistance:	50 Ω $\pm 5\%$
PIM:	-124 dBc
2 Tones	@ 20 Watts Each

2.0 MECHANICAL

Flange:	Copper, Nickel Plated
Substrate:	Aluminum Nitride
Cover:	Alumina
Tab:	Copper, Silver Plated
Resistive Film:	Thin Film

3.0 UNIT MARKING

Logo And Part Number

4.0 PACKAGING

Standard: Tray Packaging

5.0 PART NUMBERING

Part Identifier: 32P7204F

POWER RATING AND DERATING

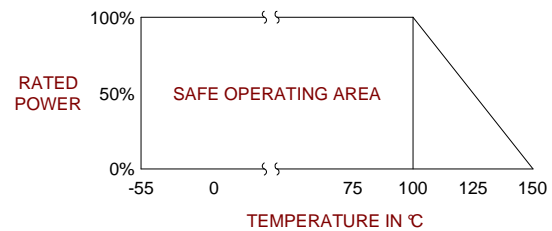

MECHANICAL OUTLINE

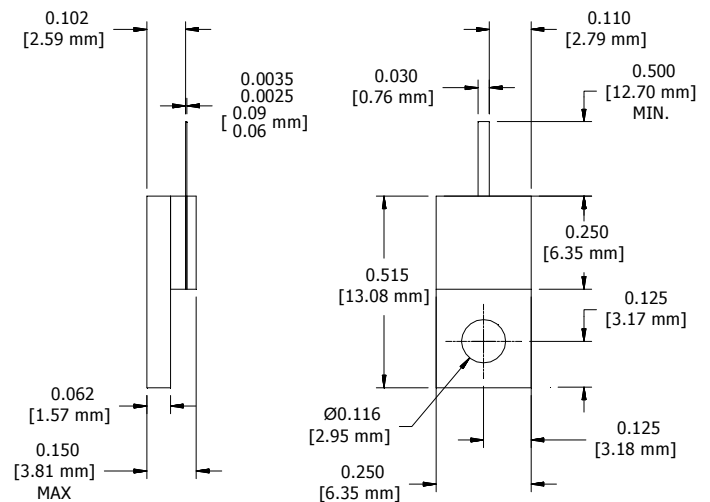

Note: Specifications are subject to change without notice.

TOLERANCE: .XX = ± 0.02
.XXX = ± 0.010