

**TITLE: SPECIFICATION CONTROL DRAWING**

**PART IDENTIFIER:** 8482

**DESCRIPTION:** 50 OHM FLANGE LOAD

**ASSEMBLY DWG:** 2100684

**1.0 SPECIFICATIONS:**

**1.1 ELECTRICAL:**

- 1.1.1 IMPEDANCE: 50 OHMS NOMINAL.
- 1.1.2 FREQUENCY RANGE: DC-14.5 GHZ.
- 1.1.3 INPUT POWER (MAX @ 60°C):
  - 1.1.3.1 AVERAGE: 25 WATTS.
  - 1.1.3.2 PEAK: 100 WATTS (100 US PULSE WIDTH AND 0.1% DUTY CYCLE).
- 1.1.4 VSWR:
  - DC TO 4.0 GHZ - 1.15 MAX.
  - 4.0 TO 8.0 GHZ - 1.25 MAX.
  - 8.0 TO 12.0 GHZ - 1.25 MAX.
  - 12.0 TO 14.5 GHZ - 1.50 MAX.

**1.2 MECHANICAL:**

- 1.2.1 OUTLINE DWG: SEE SHEET 2.
- 1.2.2 WORKMANSHIP: PER MIL-STD-454, REQUIREMENT 9.

**1.3 ENVIRONMENTAL:**

- 1.3.1 TEMPERATURE RANGE:
  - 1.3.1.1 NON-OPERATING: -55°C TO + 150°C.
  - 1.3.1.2 OPERATING: -55°C TO +125°C.
- 1.3.2 VIBRATION: PER MIL-STD-202, METHOD 201 AND MIL-D-39030.
- 1.3.3 SHOCK: PER MIL-STD-202, METHOD 213, COND. I.
- 1.3.4 MOISTURE: PER MIL-STD-202, METHOD 106 AND MIL-D-39030 EXCEPT LOADING VOLTAGE IS NOT APPLICABLE.

**2.0 UNIT MARKING:**

"EMCT"  
LEGIBILITY AND PERMANENCY PER MIL-STD-130.

**3.0 QUALITY ASSURANCE:**

- 3.1 SAMPLE INSPECT PER ANSI/ASQC Z1.4 GENERAL INSPECTION, LEVEL II, AQL = 1.0.
  - 3.1.1 VISUAL AND MECHANICAL EXAMINATION FOR CONFORMANCE TO CONTROL DRAWING REQUIREMENTS, INCLUDING SMA INTERFACE.
  - 3.1.2 MEASURE AND RECORD VSWR @ 1 TO 18 GHZ IN 1 GHZ INCREMENTS.
    - 3.1.2.1 ACCEPTANCE LIMITS: SEE ELECTRICAL 1.1.4.
- 3.2 TEST DATA REQUIREMENTS:
  - 3.2.1 NO TEST DATA REQUIRED FOR CUSTOMER.
  - 3.2.2 DATA RETENTION - STANDARD.

**4.0 PACKAGING:**

STANDARD PACK PER 755W002.

<b>EMC TECHNOLOGY</b> <b>8851 SW OLD KANSAS AVE.</b> <b>STUART, FL 34997</b>	<b>CAGE CODE # 24602</b>		<b>DWG #</b>	1000715000
	<b>CHANGE NOTICE</b>	EN 10-0911	<b>REV LVL</b>	F
			<b>SHEET</b>	1 OF 2

PART ID REF

8482

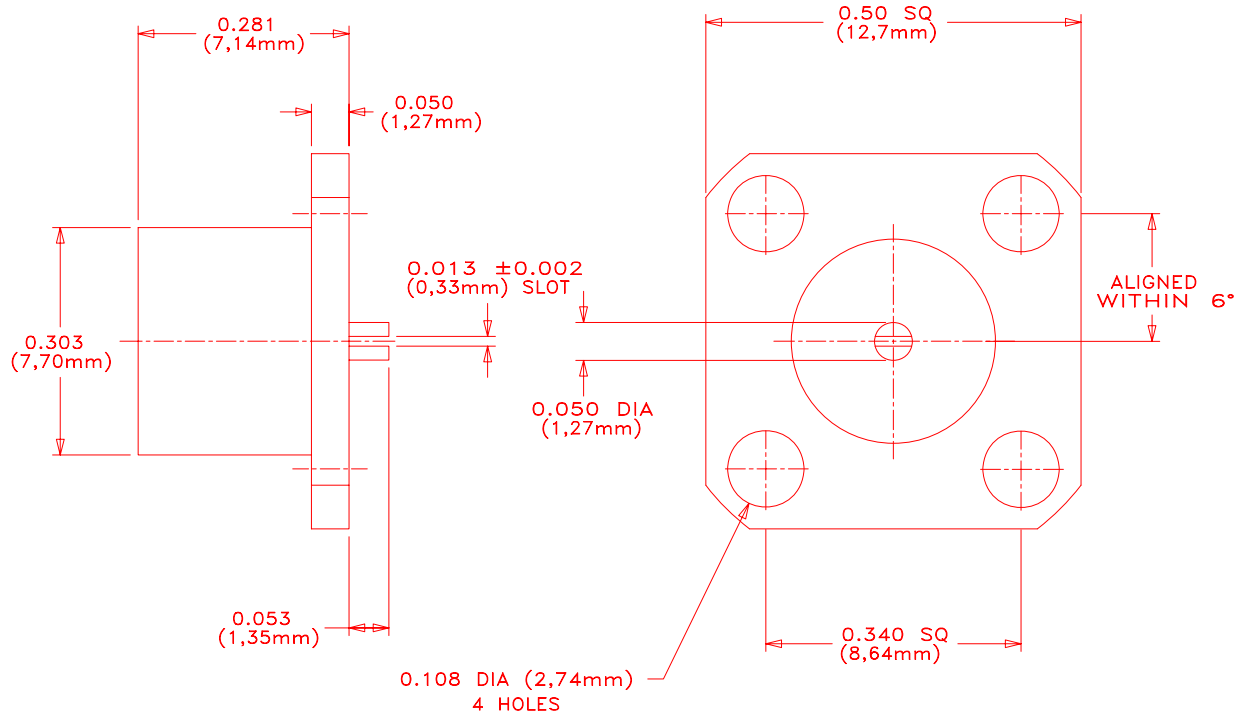

MECHANICAL SPECIFICATIONS:

CASE:

MATERIAL - ALUMINUM, QQ-A-225/3.  
FINISH - CHROMATE, MIL-C-5541.

PIN:

MATERIAL - BERYLLIUM COPPER, ASTM B197.  
FINISH - GOLD, MIL-G-45204, TYPE II, CLASS 2.

DIELECTRIC:

MATERIAL - TEFLON, ASTM D1710.

CERAMIC:

MATERIAL - BERYLLIA, ASTM F-356.

METRIC EQUIVALENTS ARE GIVEN FOR  
REFERENCE INFORMATION ONLY



8851 SW OLD KANSAS AVE  
STUART, FL 34997  
PHONE NO. (772)286-9300  
FAX NO. (772)283-5286

UNLESS OTHERWISE SPECIFIED DIMENSIONS ARE IN INCHES

TOLERANCES

FRACT	---
ANG	---
XX	±0.01
XXX	±0.005
XXXX	---

THESE DRAWINGS AND SPECIFICATIONS ARE THE PROPERTY OF EMC TECHNOLOGY INC AND SHALL NOT BE DUPLICATED OR USED AS BASIS FOR THE MANUFACTURE OR SALE OF PARTS OR DEVICES WITHOUT PERMISSION.

CAGE CODE	SCALE	DRAWN BY	CHECKED BY	APPROVED BY
24602	1:1	CME 11-2-00		DAR 11-6-00
REV	CHANGE NOTICE	DRAWING NO	SHEET	
F	EN 10-0911	1000715000	2 OF 2	