

TITLE: SPECIFICATION CONTROL DRAWING

PART IDENTIFIER: 5320

DESCRIPTION: : HIGH POWER LOAD, BERYLLIA

ASSEMBLY DWG: 1700124

1.0 SPECIFICATIONS:

1.1 ELECTRICAL:

- 1.1.1 RESISTANCE VALUE: 50Ω NOMINAL
- 1.1.2 INPUT POWER: (@ 100°C HEAT SINK, DERATED LINEARLY TO ZERO POWER AT 150°C):
 - 1.1.2.1 AVERAGE: 90 WATTS.
 - 1.1.2.2 PEAK: 900 WATTS (BASED ON 100US PULSE WIDTH AND 1% DUTY CYCLE).
- 1.1.3 FREQUENCY RANGE: DC - 4.0 GHZ
- 1.1.4 VSWR: 1.25 MAX.

1.2 MECHANICAL:

- 1.2.1 OUTLINE DWG: SEE SHEET 2.
- 1.2.2 WORKMANSHIP: PER MIL-STD-454, REQUIREMENT 9, AND MIL-R-55342.

1.3 ENVIRONMENTAL:

- 1.3.1 TEMPERATURE RANGE:
 - 1.3.1.1 STORAGE: -65°C TO +150°C.
 - 1.3.1.2 OPERATING: -55°C TO +150°C.

2.0 UNIT MARKING: "EMCT LOGO"
LEGIBILITY AND PERMANENCY PER MIL-STD-130.

3.0 QUALITY ASSURANCE:

3.1 SAMPLE INSPECT PER MIL-STD-105, LEVEL II, 1.0% AQL.

- 3.1.1 VISUAL AND MECHANICAL EXAMINATION FOR CONFORMANCE TO MIL-R-55342 AND CONTROL DRAWING REQUIREMENTS.
- 3.1.2 INSPECTION IN ACCORDANCE WITH QA0006 AND FORM0357 FOR COMMERCIAL GRADE PRODUCT.

3.2 DATA REQUIREMENTS:

- 3.2.1 NO TEST DATA REQUIRED FOR CUSTOMER.
- 3.2.2 DATA RETENTION - STANDARD.

4.0 PACKAGING: STANDARD PACKING PER 755W002.

EMC TECHNOLOGY 8851 SW OLD KANSAS AVE. STUART, FL 34997	CAGE CODE # 24602		DWG #	1001855000
	CHANGE NOTICE	EN 10-0911	REV LVL	F
			SHEET	1 OF 2

PART ID REF

5320

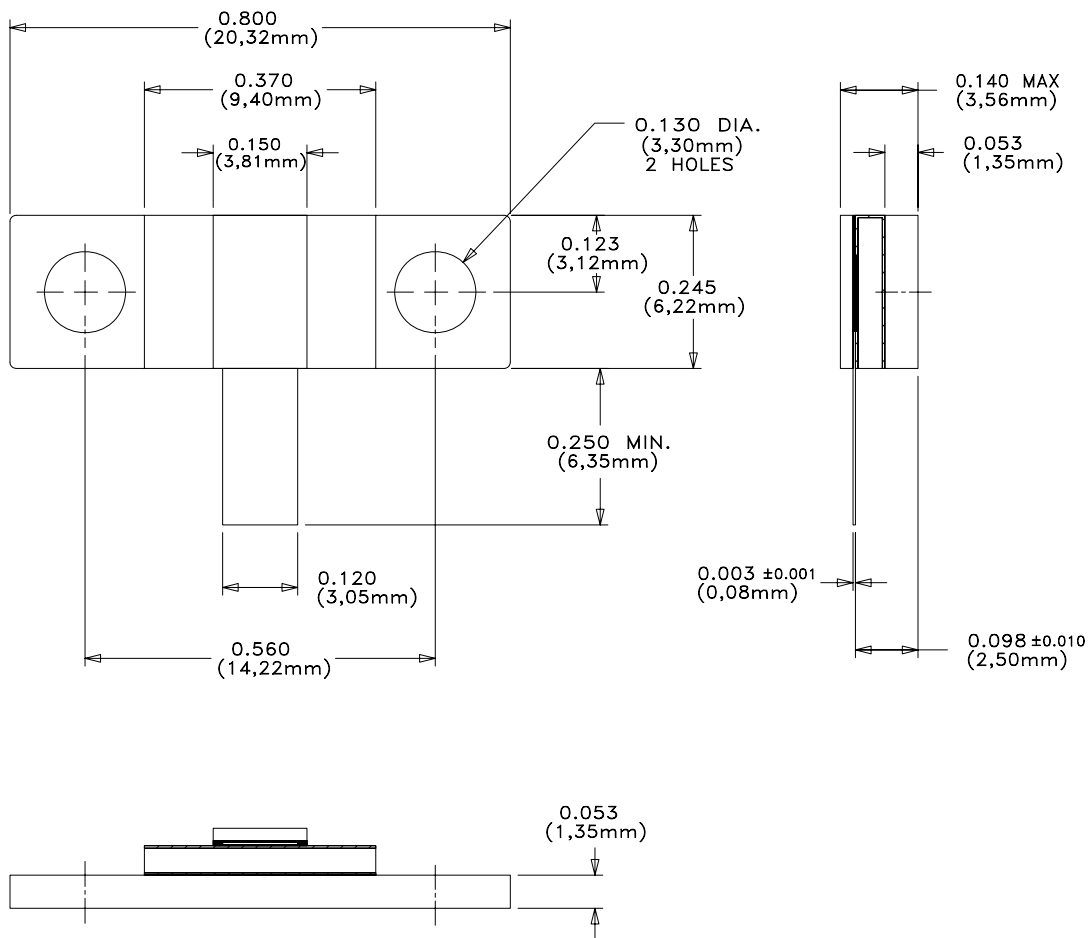
**MECHANICAL SPECIFICATIONS:****CHIP:**

MATERIAL - BERYLLIA, ASTM F356.

TOP PLATE:

MATERIAL - ALUMINA, MIL-I-10.

TAB:

MATERIAL - BRASS, ASTM B36.

FINISH - GOLD, MIL-G-45204, TYPE II, CLASS 1.

HEAT SINK:

MATERIAL - COPPER, ASTM B187.

FINISH - NICKEL, QQ-N-290.

METRIC EQUIVALENTS GIVEN IN [mm]
FOR REFERENCE INFORMATION ONLY

ALLOW ±0.010 ON TOP PLATE FOR MISALIGNMENT/SOLDER FILLET



8851 SW OLD KANSAS AVE
STUART, FL 34997
PHONE NO. (772)286-9300
FAX NO. (772)283-5286

UNLESS OTHERWISE
SPECIFIED DIMENSIONS
ARE IN INCHES**TOLERANCES**

FRACT	---
ANG	---
XX	---
XXX	±0.005
XXXX	---

THESE DRAWINGS AND SPECIFICATIONS ARE THE PROPERTY OF EMC TECHNOLOGY INC AND SHALL NOT BE DUPLICATED OR USED AS BASIS FOR THE MANUFACTURE OR SALE OF PARTS OR DEVICES WITHOUT PERMISSION.

CAGE CODE

24602

SCALE

1:1

DRAWN BY

JG 6/5/09

CHECKED BY

APPROVED BY

REV

F

CHANGE NOTICE

EN 10-0911

DRAWING NO

1001855000

SHEET

2 OF 2