

TITLE: SPECIFICATION CONTROL DRAWING
EMC PROPRIETARY

REVISIONS RECORD			
REV	SHEET	DATE	DESCRIPTION
A	1	01/23/91	ADDED 2.0 UNIT MARKING: NONE
B	1-2	04/24/97	ECN 95-125, CATALOG
C	1-2	01/04/02	EN 01-544, TRP 4-12 ROD PRODUCTS, OBS SUB ASM. UPDATE 3.0 QUALITY ASSURANCE
C	1-2	10/7/04	EN 04-E231, REMOVE SIGNATURE BLOCK, NO REV CHANGE
D	1-2	10/7/13	EN 13-2976, UPDATE PART IDENTIFIER & TOLERANCE

EMC TECHNOLOGY 8851 SW OLD KANSAS AVE. STUART, FL 34997	CAGE CODE # 24602	DWG# 1001565000	SHEET	REF
			REV LEVEL	D

TITLE: SPECIFICATION CONTROL DRAWING

PART IDENTIFIER:

TRP 4-12 X,5



DESCRIPTION: : ROD RESISTOR, BERYLLIA

ASSEMBLY DWG: 1300024

1.0 SPECIFICATIONS:

- 1.1 ELECTRICAL:
 - 1.1.1 RESISTANCE RANGE: 10Ω TO 250Ω.
 - 1.1.2 TOLERANCE: 5%.
 - 1.1.3 INPUT POWER:
 - 1.1.3.1 IN AIR 125°C: 0.1 WATT.
 - 1.1.3.2 HEAT SINK 100°C: 2 WATTS.
- 1.2 MECHANICAL:
 - 1.2.1 OUTLINE DWG: SEE SHEET 2.
- 1.3 ENVIRONMENTAL:
 - 1.3.1 TEMPERATURE RANGE:
 - 1.3.1.1 NON-OPERATING: -55° C TO +150° C.
 - 1.3.1.2 OPERATING: -55°C TO +125°C.

2.0 UNIT MARKING: NONE

3.0 QUALITY ASSURANCE:

- 3.1 VISUAL INSPECTION:
 - 3.1.1 SAMPLE INSPECT PER ANSI/ASQC Z1.4 GENERAL INSPECTION, LEVEL II, AQL = 1.0.
 - 3.1.2 VISUAL AND MECHANICAL EXAMINATION FOR CONFORMANCE TO CONTROL DRAWING REQUIREMENTS.
- 3.2 100% DCR CHECK:
 - 3.2.1 ACCEPTANCE LIMITS: RESISTANCE VALUES AND TOLERANCE AS SPECIFIED ON PART ROUTING.
- 3.3 SAMPLE DCR CHECK. 5% TOLERANCE ONLY.
 - 3.3.1 SAMPLE INSPECT PER ANSI/ASQC Z1.4 GENERAL INSPECTION, LEVEL II, AQL = 1.0.
 - 3.3.2 ACCEPTANCE LIMITS: RESISTANCE VALUES AND TOLERANCE AS SPECIFIED ON PART ROUTING.

4.0 PACKAGING: STANDARD PACKING PER MC0023.

EMC TECHNOLOGY 8851 SW OLD KANSAS AVE. STUART, FL 34997	CAGE CODE # 24602		DWG #	1001565000
	CHANGE NOTICE	EN 13-2976	REV LVL	D
			SHEET	1 OF 2

PART ID REF

TRP 4-12

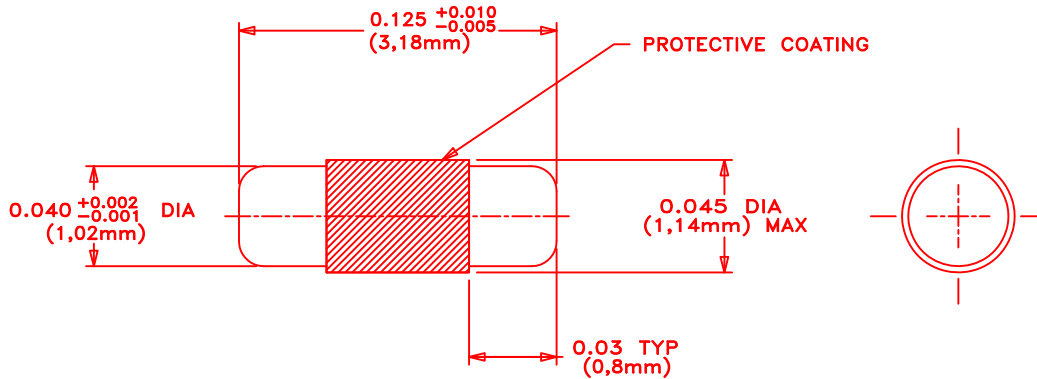

MECHANICAL SPECIFICATIONS:

SUBSTRATE:
MATERIAL - BERYLLIA 99.5%, ASTM F356

TERMINAL:
MATERIAL - GOLD OVER NICKEL PLATING.

**METRIC EQUIVALENTS ARE GIVEN FOR
 REFERENCE INFORMATION ONLY**



8851 SW OLD KANSAS AVE
 STUART, FL 34997
 PHONE NO. (772)286-9300
 FAX NO. (772)283-5286

UNLESS OTHERWISE SPECIFIED DIMENSIONS ARE IN INCHES

TOLERANCES

FRACT	---
ANG	---
XX	±0.01
XXX	±0.005
XXXX	---

THESE DRAWINGS AND SPECIFICATIONS ARE THE PROPERTY OF EMC TECHNOLOGY INC AND SHALL NOT BE DUPLICATED OR USED AS BASIS FOR THE MANUFACTURE OR SALE OF PARTS OR DEVICES WITHOUT PERMISSION.

CAGE CODE	SCALE	DRAWN BY	CHECKED BY	APPROVED BY
24602	1:1	BC 1/4/02		DAR 1/4/02
REV	CHANGE NOTICE	DRAWING NO	SHEET	
D	EN 13-2976	1001565000	2 OF 2	