

# TERMINATION FLANGE MOUNT 800 WATT



DATA SHEET

PART SERIES: 32A7205F

SHEET 1 OF 2  
1013455

EN 15-0267  
Revision A

## FEATURES

- Tab Launch
- High Power
- Integrated Heat Sink
- Low VSWR
- Easy Installation

## APPLICATIONS

- Mobile Networks
- Broadcast
- High Power Amplifiers
- Isolators
- Military
- Instrumentation

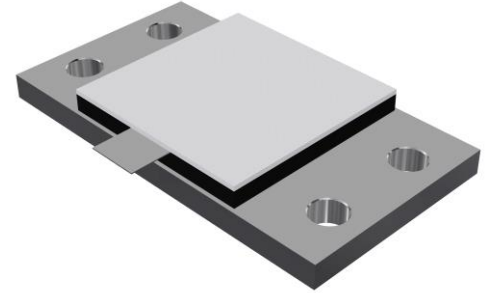

## GENERAL DESCRIPTION

EMC Technology offers the widest selection of flange mount terminations worldwide. High power flange components offer excellent performance and the convenience of bolt on installation.

## ORDERING INFORMATION

Part Identifier: **32A7205F**

## SPECIFICATIONS

### 1.0 ELECTRICAL

Nominal Impedance:	50 ohms
Frequency Range:	DC - 900 MHz
VSWR:	DC – 900 MHz 1.25:1 max, DC – 300 MHz 1.10:1 max, 698 – 900 MHz 1.20:1 max
Input Power CW:	800 Watts @ 100°C heat sink, derated linearly to zero power and 150°C
Peak Power:	8000 Watts (based on 10 µs pulse width and 1% duty cycle)
DC Resistance:	50 Ω ± 5%

### 2.0 ENVIRONMENTAL

Operating Temperature:	-55°C to +150°C
Non-operating Temperature:	-65°C to +150°C
Temperature Coefficient:	± 200 PPM / °C max

### 3.0 MARKING

Unit Marking:	Logo and Part Number
---------------	----------------------

### 4.0 QUALITY ASSURANCE

Visual and Mechanical Inspection:	Per 824W107
DC Resistance Check:	100% DC Resistance Check
Data Retention:	Standard

### 5.0 PACKAGING

Standard Packaging:	Tray Packaging
---------------------	----------------

# TERMINATION FLANGE MOUNT 800 WATT



DATA SHEET

PART SERIES: 32A7205F

SHEET 2 OF 2  
1013455

EN 15-0267  
Revision A

## 6.0 MECHANICAL

Substrate Material:	Aluminum Nitride
Resistive Film:	Thin Film
Tab Material:	Be/Cu
Tab Finish:	Silver Plated
Flange Material:	Copper
Flange Finish:	Nickel Plated
Metric Dimensions:	Provided for reference only

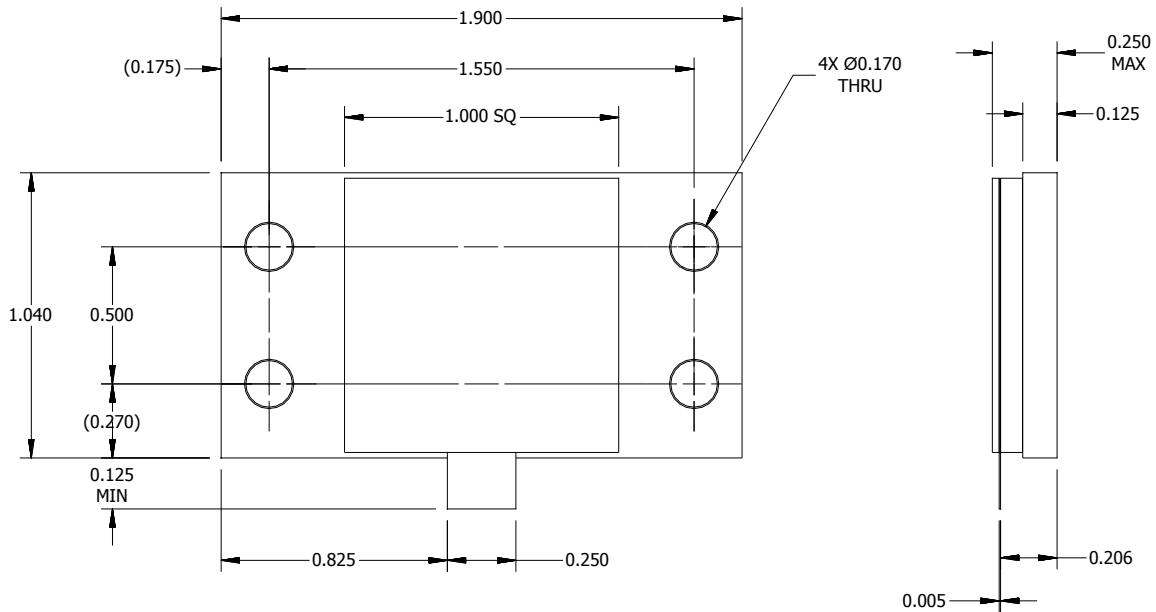
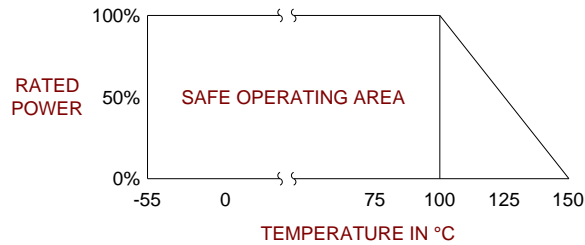

Unless Otherwise Specified: TOLERANCE: X.XX = ± 0.02 X.XXX = ± 0.010