

KMC SERIES

High Density PCB Connectors

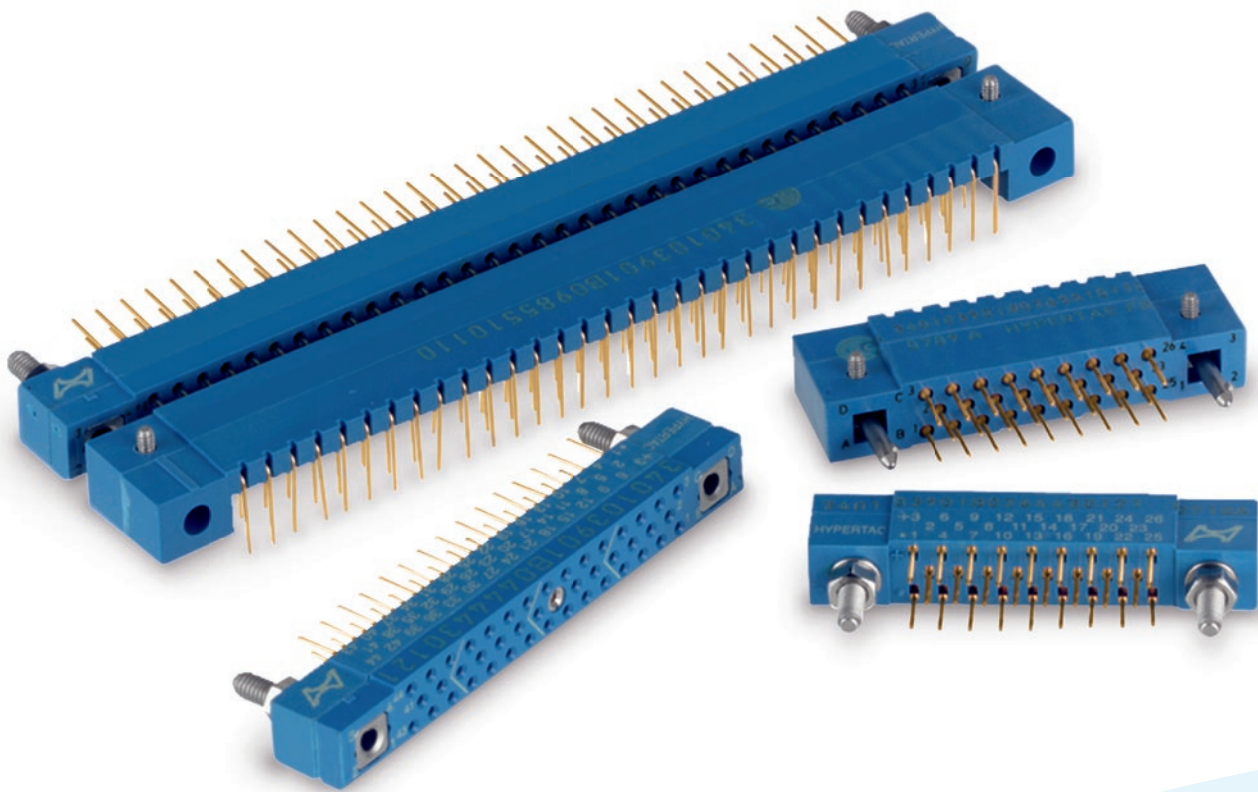

TECHNICAL CHARACTERISTICS

Contact diameter	HYPERTAC® type Ø 0.50 mm rear removable
Number of contact	Up to 162
Pitch	1.905mm between rows 1.27mm between quicuncial contacts
Rows	3

MATERIALS & PLATINGS

Contact	Brass or bronze	
Moulding	Glass fiber filled diallyl - Phtalate	
Guides	Stainless steel or nickel plated brass	
	Standard	ESA
Pin body	0.25 µm Gold / 1.27 µm Ni	1.27 µm Gold / 1.27 µm Ni (min)
Socket body	0.25 µm Gold / 1.27 µm Ni on activ area 1.27 µm Ni on non activ area	0.25 µm Gold / 1.27 µm Ni (min)
Socket wires	1 µm Gold / 0.20 µm Ni	1.27 µm Gold / 0.20 µm Ni (min)

ELECTRICAL

Current rating (at 25°C)	3 A max
Dielectric withstanding voltage	800 Vrms
Contact resistance	≤ 8 mΩ
Insulation resistance	> 10 ⁴ mΩ (500 Vcc)

MECHANICAL

Mating & unmating cycle	5000
Guiding	By two outside guides (2 guiding styles) and one central guide (3 guidind styles)
Keying	By rotating of outside polarised guides (up to 16 keying)

ENVIRONMENTAL

Temperature range	-55° C + 125° C
Conformity	ESA/ESCC 3401/039, NF C-UTE C 93-424

Dimension are in mm

HOW TO ORDER

HYPERTAC & ESA CORRESPONDANCE TABLE

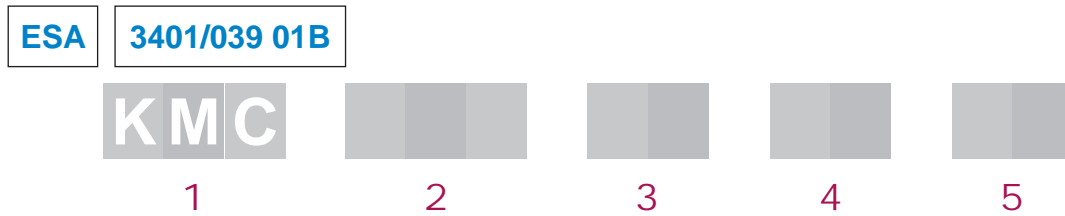

1 ▶ SERIES

2 ▶ NUMBER OF CONTACTS

0 2 6 0 4 4 0 6 2 0 8 0 0 9 8 1 4 4 1 6 2

3 ▶ MOULDING POLARITY

NF C-UTE C 93-424 ESA/ESCC 3401/03901B SPACE GRADE

12	-	54	Female plug	1A	-	-	Tinned female plug**	26	-	46	Tinned female receptacle*
13	55	55	Male plug	1B	-	-	Tinned male plug**	27	-	47	Tinned male receptacle*
16	-	56	Tinned female plug*	22	44	44	Female receptacle	2A	-	-	Tinned female receptacle**
17	-	57	Tinned male plug*	23	-	45	Male receptacle	2B	-	-	Tinned male receptacle**

4 ▶ TERMINATION STYLES

1 0	90° length 3 mm ("A" moulding)	3 0	Through board solder - straight - length 4.5 mm	5 1	Wire wrap (3 wrapping levels)
1 0	90° length 3 mm ("B" moulding)	3 1	Through board solder - straight - length 5.6 mm	9 0	Male - male
1 1	90° length 4 mm ("A" moulding)	4 0	Solder bucket	9 1	Female - male
1 3	90° length 5.5 mm ("B" moulding)	5 0	Wire wrap (2 wrapping levels)		

5 ▶ MOUNTING HARDWARE

GUIDE STYLES (consult us for special guides)

1 10	Male polarised, transverse mount ⁽¹⁾	1 27	Male unpolarised, vertical mount ⁽²⁾	1 56	Male unpolarised, transverse mount ⁽²⁾
1 11	Male polarised, vertical mount ⁽²⁾	1 28	Male unpolarised, float mount ⁽²⁾	1 73	Female unpolarised, transverse mount ⁽¹⁾
1 12	Male polarised, vertical mount ⁽²⁾	1 30	Female unpolarised, vertical mount ⁽²⁾	1 74	Female polarised, transverse mount ⁽¹⁾
1 13	Male polarised, float mount ⁽²⁾	1 33	Female unpolarised, transverse mount ⁽²⁾	1 90	Female power or mass contact, vertical mount ⁽²⁾
1 21	Female polarised, vertical mount ⁽²⁾	1 43	Female polarised, vertical mount ⁽²⁾	1 91	Male power or mass contact, transverse mount ⁽¹⁾
1 23	Female polarised, float mount ⁽²⁾	1 53	Female unpolarised, transverse mount ⁽²⁾	7 03	Female - male unpolarised guide ⁽²⁾
1 24	Female polarised, transverse mount ⁽²⁾	1 54	Female polarised, transverse mount ⁽²⁾		
1 25	Male unpolarised, transverse mount ⁽¹⁾	1 55	Male unpolarised, transverse mount ⁽²⁾		

LOCKING STYLES

FEMALE		MALE	
2 02	Jackscrew, vertical mount ⁽²⁾	2 01	Jackscrew, free connector ⁽²⁾
2 03	Jackscrew, transverse mount ⁽¹⁾	2 05	Jackscrew, transverse mount ⁽¹⁾
2 04	Jackscrew, transverse mount ⁽²⁾	2 06	Jackscrew, free connector ⁽²⁾
2 07	Jackscrew, vertical mount ⁽²⁾		

⁽¹⁾ Moulding A - ⁽²⁾ Moulding B

* For 90° & straight terminations (splicing on PCB)
 ** RoHS conform for 90° & straight terminations (splicing on PCB)

► MOULDING STYLES

PLUG

RECEPTACLE

ONE PART (moulding A)

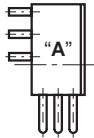

Fitted with male contacts
 ▶ 90° through board solder

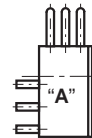

Fitted with male contacts
 ▶ 90° through board solder
 (same design as the "A" plug type but printed as receptacle)

TWO PARTS (moulding B)

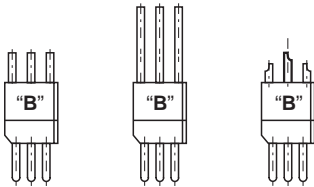

Fitted with male contacts (pins)
 ▶ Straight through board solder
 ▶ Wire wrap type
 (2 and 3 wrapping levels)
 ▶ Solder bucket

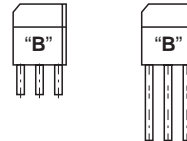

Fitted with female contacts
 ▶ Straight through board solder
 ▶ Wire wrap type
 (2 and 3 wrapping levels)
 ▶ Solder bucket
 (same design as the "B" plug type but printed as receptacle)

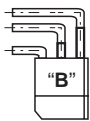

Fitted with female contacts (sockets)
 ▶ 90° through board solder
Note: the spacing of the rows for board preparation is different to the spacing of the plug fitted with the 90° termination
 ▶ Straight through board solder
 ▶ Wire wrap type
 (2 and 3 wrapping levels)
 ▶ Solder bucket



Fitted with female contacts (sockets)
 ▶ 90° through board solder
Note: the spacing of the rows for board preparation is different to the spacing of the plug fitted with the 90° termination

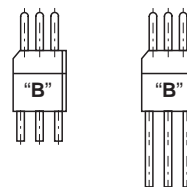
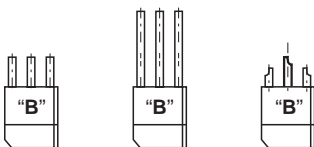

Fitted with male contacts (pins)
 ▶ Straight through board solder
 ▶ Wire wrap type
 (2 and 3 wrapping levels)
 ▶ Solder bucket
 (same design as the "B" plug type but printed as receptacle)

CONTACT TERMINATIONS

PLUG

RECEPTACLE

MALE

FEMALE

FEMALE

MALE

90° THROUGH BOARD SOLDER

Ref: 10 Ref : 10 (only A Moulding)

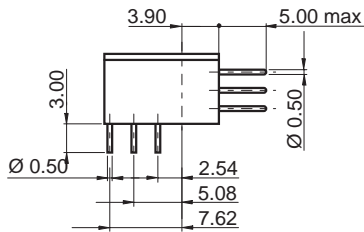

Moulding "A"

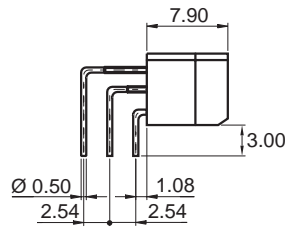

Moulding "B"

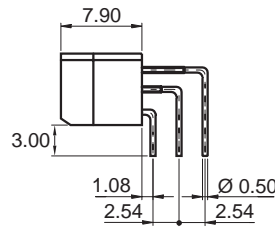

Moulding "B"

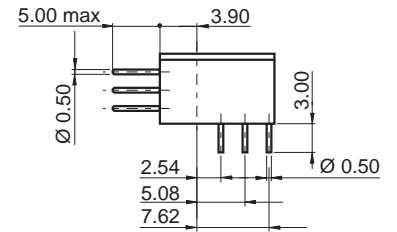

Moulding "A"

90° THROUGH BOARD SOLDER

Moulding A Ref: 11 (X=4.00) Moulding B Ref: 13 (X=5.50)

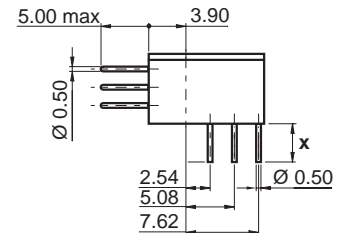
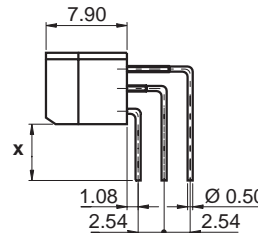
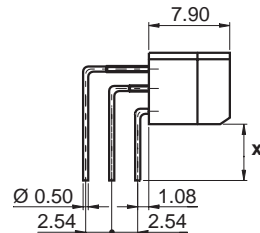
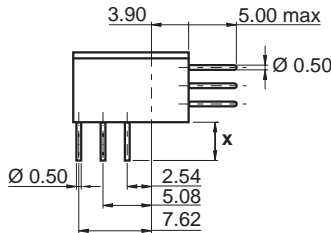

STRAIGHT THROUGH BOARD SOLDER

Ref: 30 (X=4.50) Ref : 30 Ref: 31 (X=5.60) Ref : 31

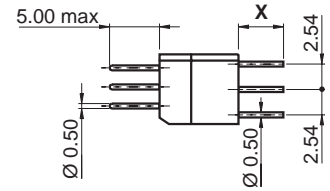
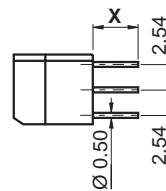
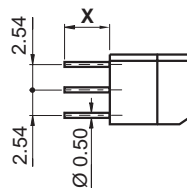
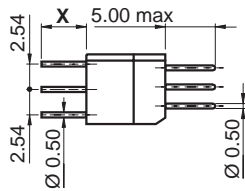

SOLDER BUCKET (AWG 26 max)

Ref: 40 Ref : 40

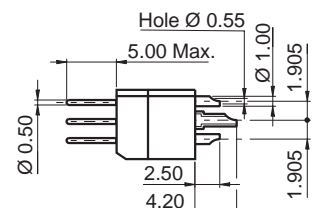
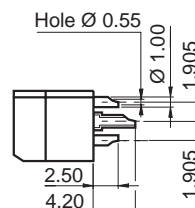
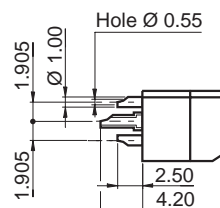
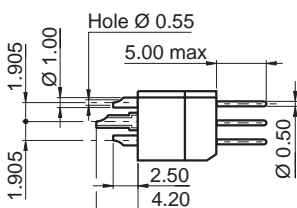

Note: moulding A and B need different preparation board details for 90° tail termination.

CONTACT TERMINATIONS

PLUG

RECEPTACLE

MALE

FEMALE

FEMALE

MALE

WIRE WRAP (2 wrapping levels)

Ref: 50 Ref: 50

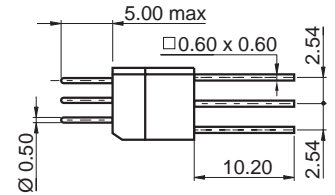
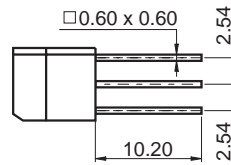
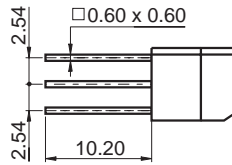
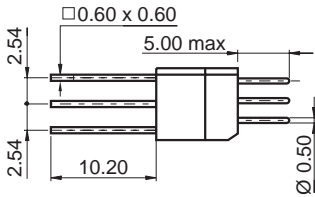

WIRE WRAP (3 wrapping levels)

Ref: 51 Ref: 51

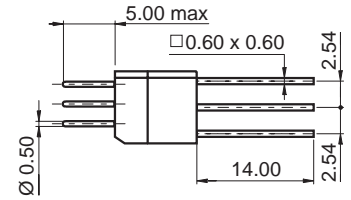
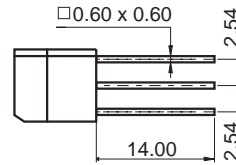
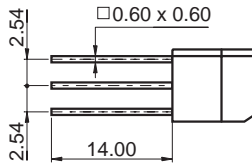
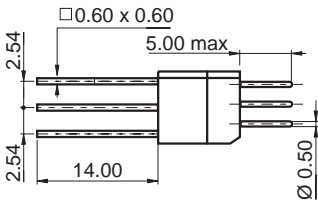

SAVER (Male-Male)

Ref: 90

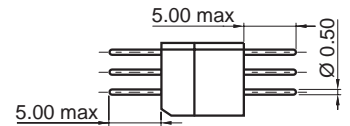
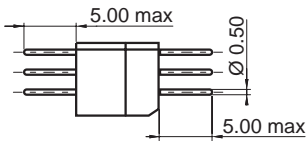

SAVER (Female-Male)

Ref: 91 Ref: 91

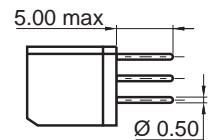
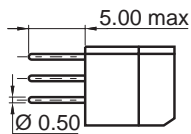

Note: moulding A and B need different preparation board details for 90° tail termination.

► DIMENSIONS

26 TO 98 CONTACTS

144 TO 162 CONTACTS

ONE PART (moulding A)

90° male plug KMC ... 13 10 ...
 90° male receptacle KMC ... 23 10 ...

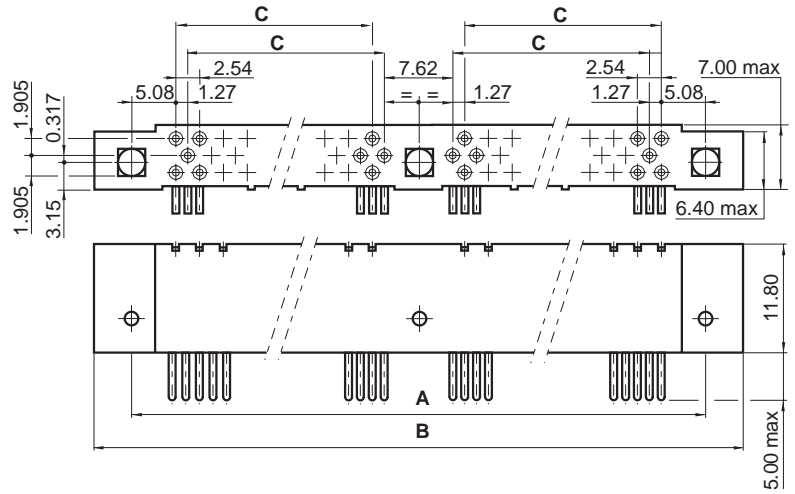
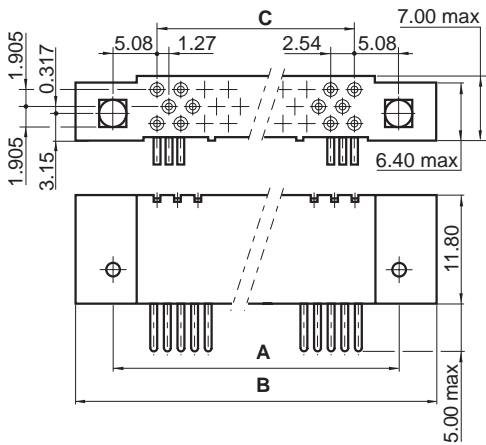

TWO PARTS (moulding B)

Female or male receptacle KMC ... 2. ...
 Female or male plug KMC ... 1. ...

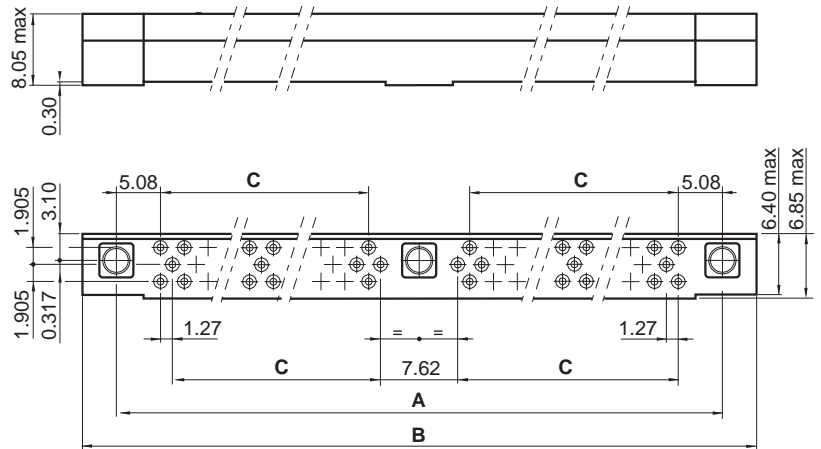
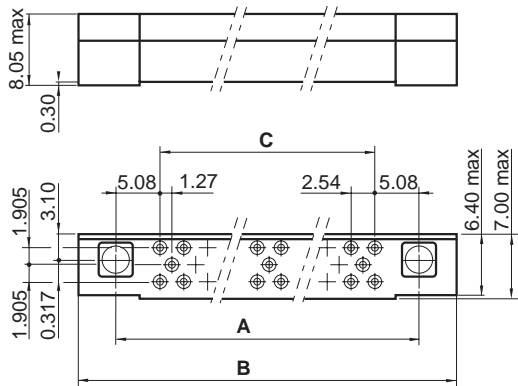

No. of contacts	26	44	62	80	98	144	162
A	30.48	45.72	60.96	76.20	91.44	137.16	152.40
B max	38.50	53.70	69.00	84.20	99.50	145.20	160.40
C	20.32	35.56	50.80	66.04	81.28	58.42	66.04

FR 22	FP 12	FR 22	FP 12	MR 23	FR 22	FP 12	MP 13	MR 23	FR 22	FP 12	MP 13	FR 22	FP 12	MR 23	FR 22	FP 12	MP 13	Polarity				Moulding	
																		All pinning	A				
																			All pinning	B			
																			90°	13F	11M	10	Contact
																			Straight		31	30	
																			Solder bucket			40	
																			Wire wrap		51	50	
																			Female/male	Male/male	91	90	

																							703
																							191
																							156
																							155
																							128
																							127
																							125
																							113
																							112 111
																							110

Guide devices

Male guides

153	133	130	123	124	143/121
Guide devices					

Female guides

▶ MALE GUIDE STYLES

POLARISED TRANSVERSE MOUNT (moulding A)

Ref: 110 Ref:  110

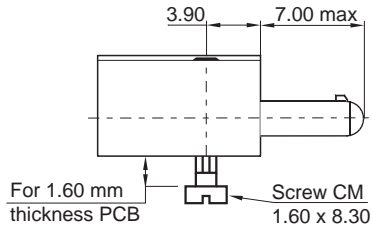

UNPOLARISED TRANSVERSE MOUNT (moulding A) CENTRAL GUIDE (KMC 144-162)

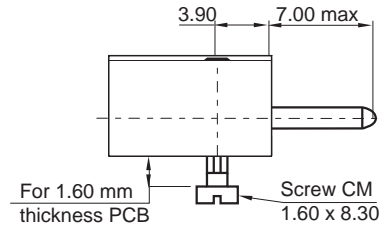

POLARISED VERTICAL MOUNT (moulding B)

Ref: 111 Ref: 112

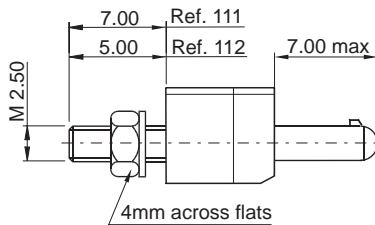

UNPOLARISED VERTICAL MOUNT (moulding B) CENTRAL GUIDE (KMC 144-162)

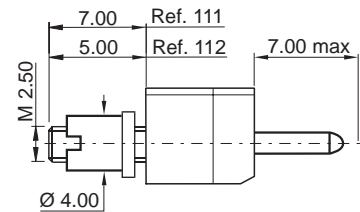

POLARISED VERTICAL FLOAT MOUNT (moulding B)

Ref: 113

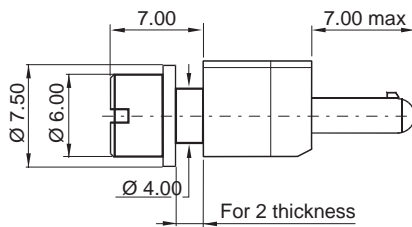

UNPOLARISED VERTICAL FLOAT MOUNT (moulding B) CENTRAL GUIDE (KMC 144-162)

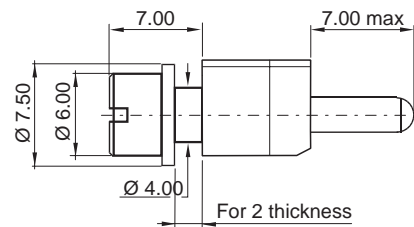

POLARISED VERTICAL FLOAT MOUNT (moulding B)

Ref: 128

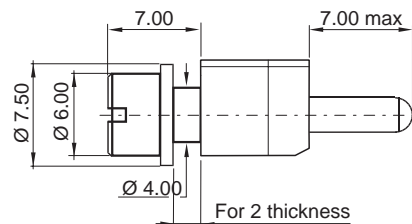

▶ MALE GUIDE STYLES

UNPOLARISED TRANSVERSE MOUNT (moulding A)

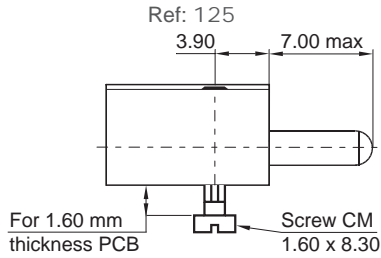

UNPOLARISED TRANSVERSE MOUNT (moulding A) CENTRAL GUIDE (KMC 144-162)

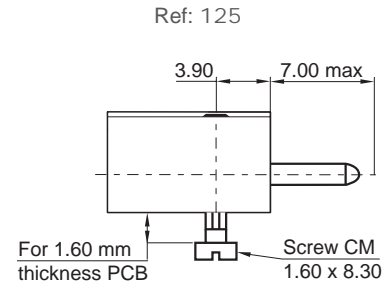

UNPOLARISED VERTICAL MOUNT (moulding B)

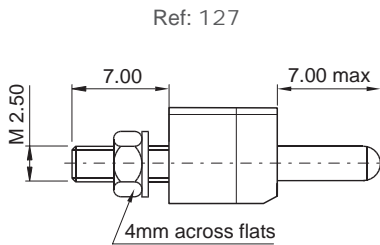

UNPOLARISED VERTICAL MOUNT (moulding B) CENTRAL GUIDE (KMC 144-162)

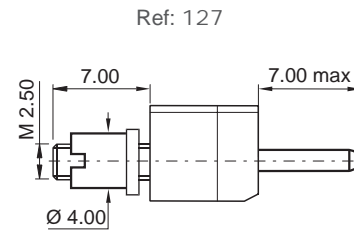

UNPOLARISED TRANSVERSE MOUNT (moulding B)

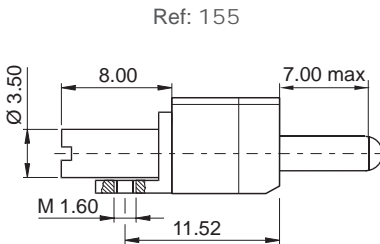

UNPOLARISED TRANSVERSE MOUNT (moulding B) CENTRAL GUIDE (KMC 144-162)

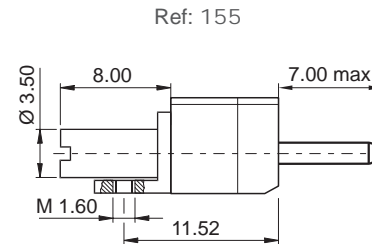

POLARISED TRANSVERSE MOUNT (moulding B)

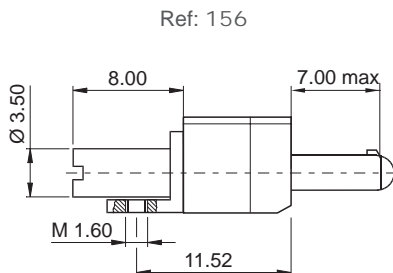

UNPOLARISED TRANSVERSE MOUNT (Moulding B) CENTRAL GUIDE (KMC 144-162)

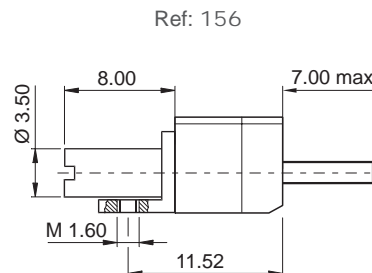

► FEMALE GUIDE STYLES

POLARISED VERTICAL MOUNT (moulding B)

Ref. 121 Ref. 143 Ref. 143

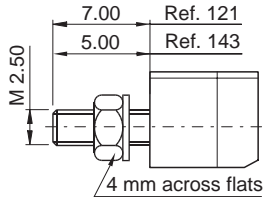

UNPOLARISED VERTICAL MOUNT (moulding B) CENTRAL GUIDE (KMC 144-162)

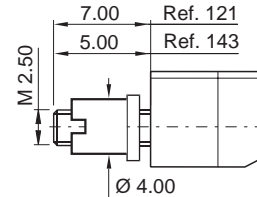

POLARISED TRANSVERSE MOUNT (moulding B)

Ref: 124

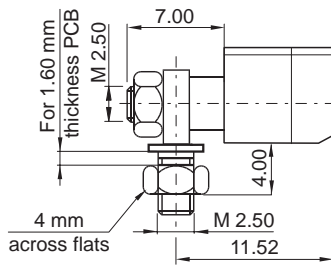

UNPOLARISED TRANSVERSE MOUNT (moulding B) CENTRAL GUIDE (KMC 144-162)

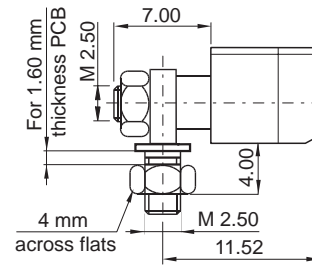

POLARISED VERTICAL FLOAT MOUNT (moulding B)

Ref: 123

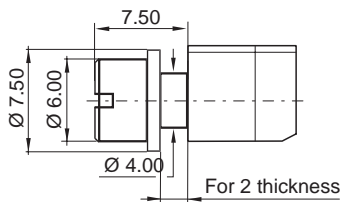

ALL KEYING TYPES (moulding B)

Ref: 130

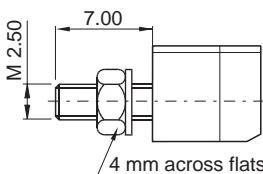

ALL KEYING TYPES (moulding B) CENTRAL GUIDE (KMC 144-162)

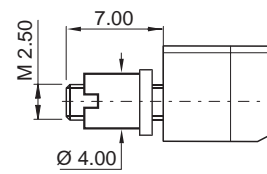

▶ FEMALE GUIDE STYLES

**ALL KEYING TYPES
(moulding B)**

Ref: 133

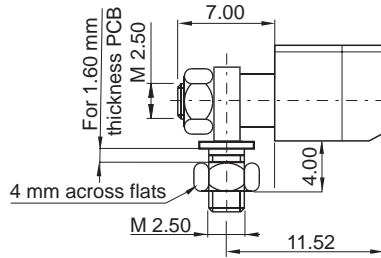

**ALL KEYING TYPES (moulding B)
CENTRAL GUIDE (KMC 144-162)**

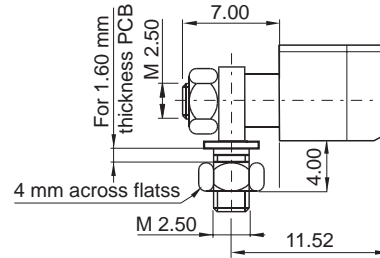

**ALL KEYING TYPES
(moulding B)**

Ref: 153

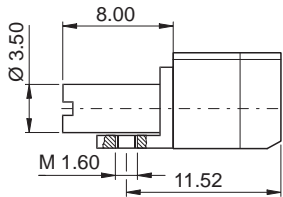

**ALL KEYING TYPES (moulding B)
CENTRAL GUIDE (KMC 144-162)**

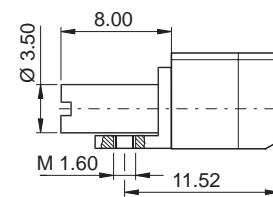

**POLARISED TRANSVERSE MOUNT
(moulding B)**

Ref: 154

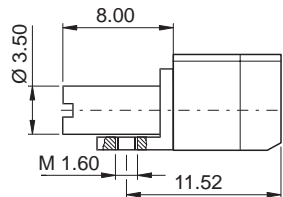

**UNPOLARISED TRANSVERSE MOUNT (moulding B)
CENTRAL GUIDE (KMC 144-162)**

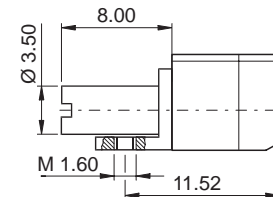

GUIDE STYLES

FEMALE

UNPOLARISED TRANSVERSE MOUNT (moulding A)

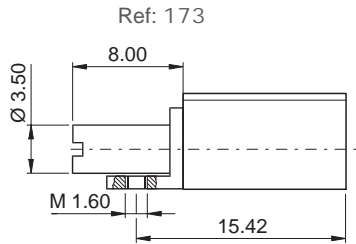

UNPOLARISED TRANSVERSE MOUNT (moulding A) CENTRAL GUIDE (KMC 144-162)

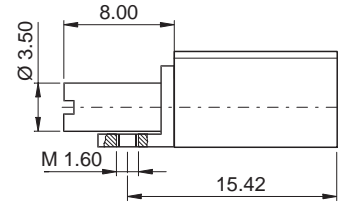

POLARISED TRANSVERSE MOUNT (moulding A)

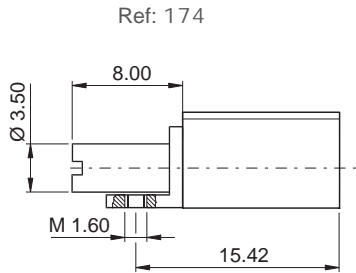

UNPOLARISED TRANSVERSE MOUNT (moulding A) CENTRAL GUIDE (KMC 144-162)

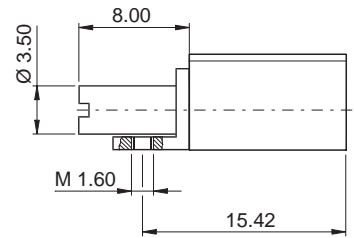

FEMALE

MALE

MASS AND POWER CONTACT (moulding B)

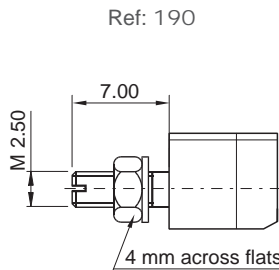

MASS AND POWER CONTACT (moulding A)

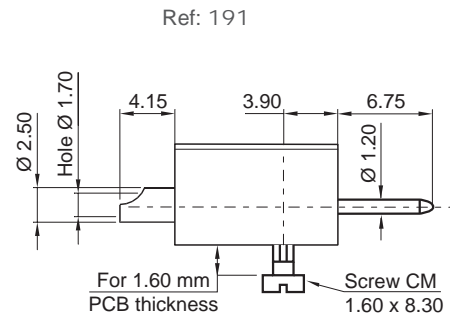

FEMALE - MALE

UNPOLARISED TRANSVERSE MOUNT (moulding B)

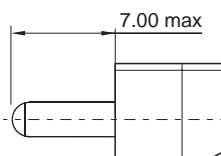

Ref: 703 Ref: 703

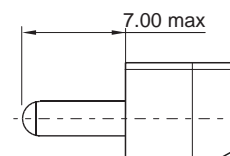

UNPOLARISED TRANSVERSE MOUNT (moulding B) CENTRAL GUIDE (KMC 144-162)

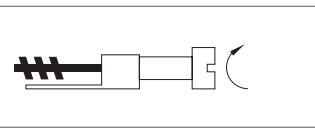
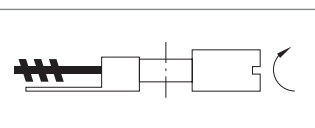
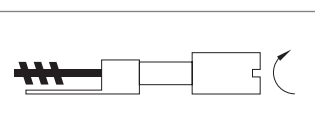
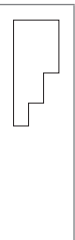
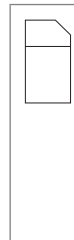
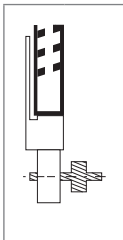
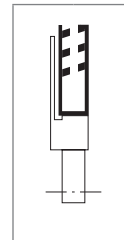
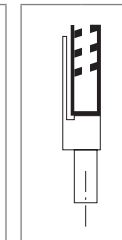

▶ LOCKING DEVICE COMPATIBILITY CHART

						A	Moulding
						B	
							206
							205
							201
					Male locking devices		
A	B				Female locking devices		
Moulding		204	203	202/207			

 Compatible

NOTE: the connector must be fitted with its locking devices before soldering on the PCB (straight through board solder):

- ▶ Connector on PCB: impossibility to change the keying.
 - ▶ If you need to change the keying:
 - pierce PCB through Ø 3.70, fixing devices
 - use 054826.000R shouldered washer
- } (for 202 and 207)

▶ LOCKING STYLES

MALE

JACKSCREW, FREE CONNECTOR (moulding B)

Ref: 201 Ref : 201
 For KMC 144-162 the supplied central guide is Ref: 111

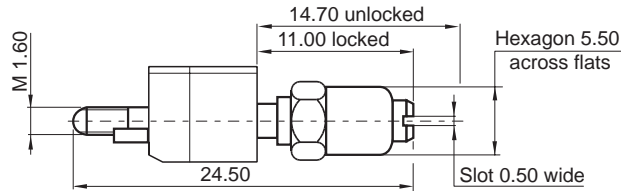

JACKSCREW, TRANSVERSE MOUNT (moulding A)

Ref: 205
 For KMC 144-162 the supplied central guide is Ref: 110

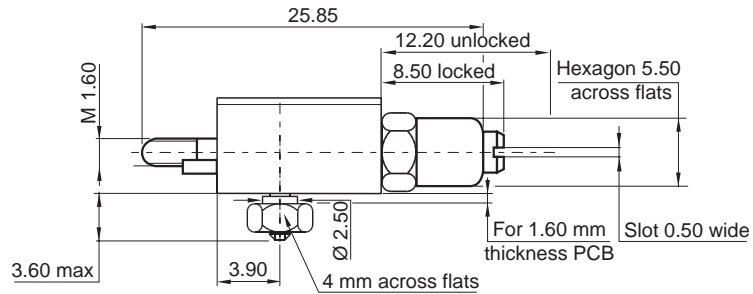

JACKSCREW, FREE CONNECTOR (moulding B)

Ref: 206 Ref : 206
 For KMC 144-162 the supplied central guide is Ref: 112

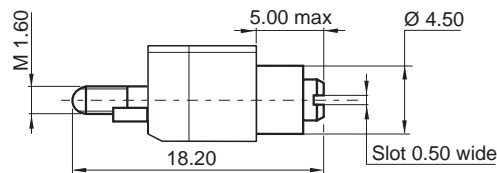

▶ LOCKING STYLES

FEMALE

NON ROTATING JACKSCREW, VERTICAL MOUNT (moulding B)

Ref: 202 Ref: 207

For KMC 144-162 jackscrew 202 the supplied central guide is Ref: 121

Ref: 207

jackscrew 207 the supplied central guide is Ref: 143

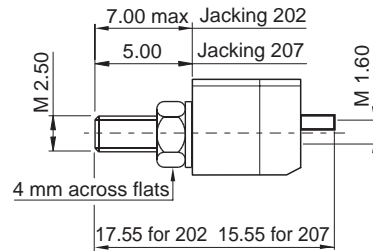

NON ROTATING JACKSCREW, TRANSVERSE MOUNT (moulding A)

Ref: 203

For KMC 144-162 jackscrew 202 the supplied central guide is Ref: 173

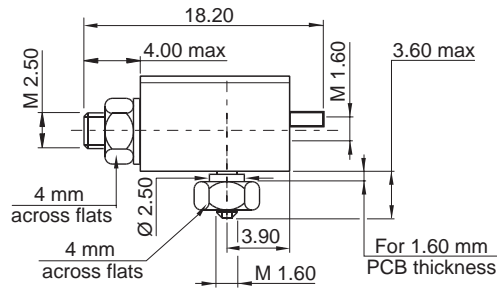

NON ROTATING JACKSCREW, TRANSVERSE MOUNT (moulding B)

Ref: 204 Ref: 204

For KMC 144-162 the supplied central guide is Ref: 111

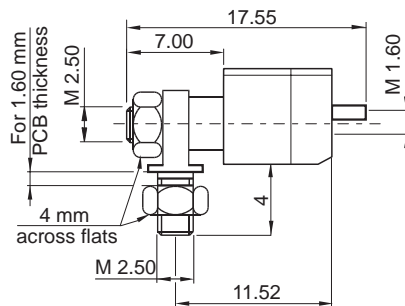

▶ MATING SIDE LAYOUT VIEW

MOULDING A

PLUG

RECEPTACLE

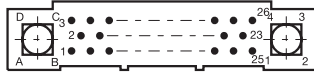

026



044

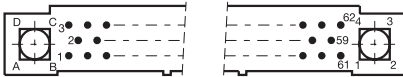
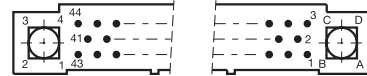

062

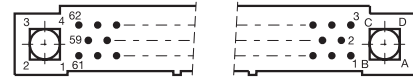

080



098

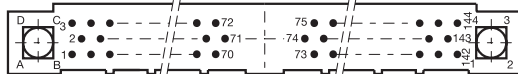

144

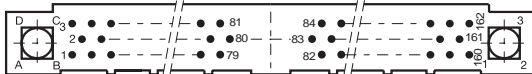
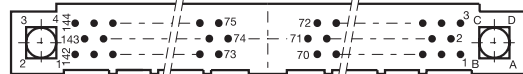

162



▶ MATING SIDE LAYOUT VIEW

MOULDING B

PLUG

RECEPTACLE

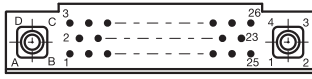

026

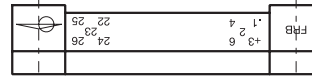

044

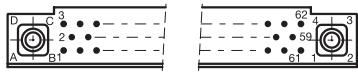
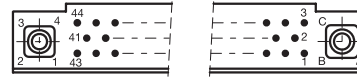

062

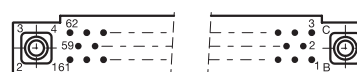

080

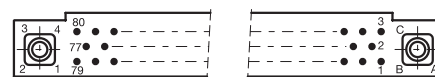

098

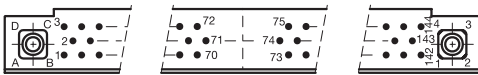

144

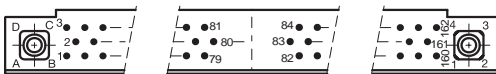
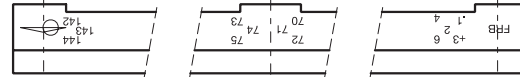
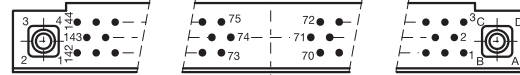

162



▶ BOARD PREPARATION DETAILS

TWO PARTS (moulding B)

26 TO 98 CONTACTS

144 TO 162 CONTACTS

MOTHER BOARD

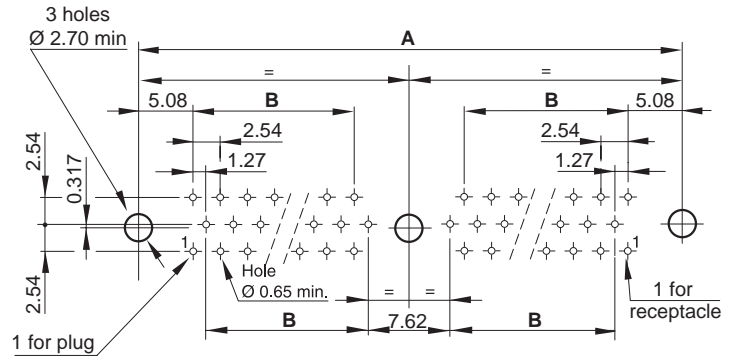
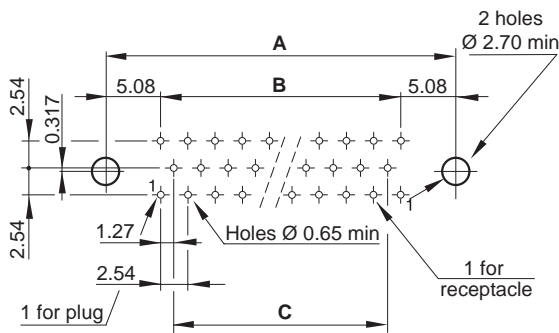

Female or male, plug or receptacle, straight solder terminations 30 or 31
Guide styles: 111 - 112 - 121 - 127 - 130 - 143 - 190

DAUGHTER BOARD

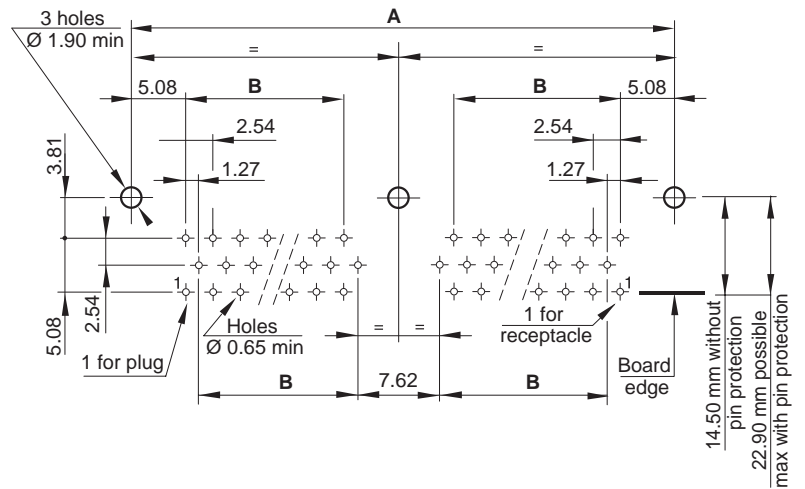
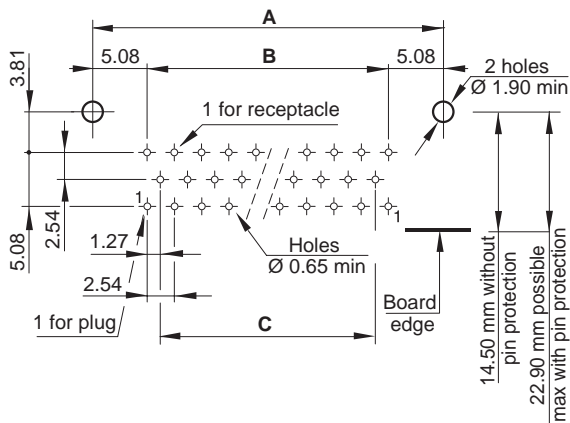

Female or male, plug or receptacle, 90° termination
Guide styles: 153 - 154 - 155 - 156

No. of contacts	26	44	62	80	98	144	162
A	30.48	45.72	60.96	76.20	91.44	137.16	152.40
B	20.32	35.56	50.80	66.04	81.28	58.42	66.04
C	17.78	33.02	48.26	63.50	78.74	-	-

▶ BOARD PREPARATION DETAILS

TWO PARTS (moulding B)

26 TO 98 CONTACTS

144 TO 162 CONTACTS

DAUGHTER BOARD

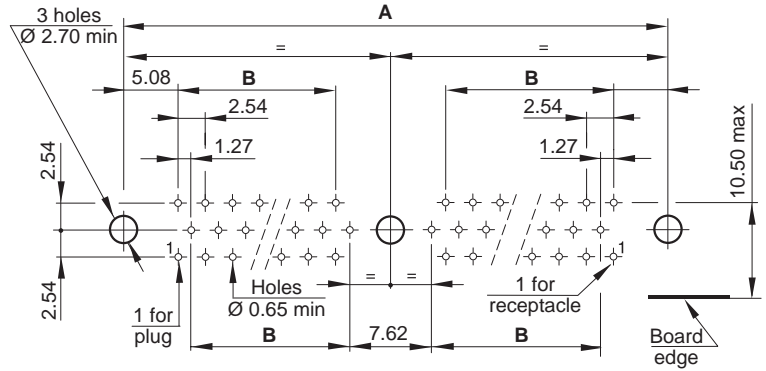
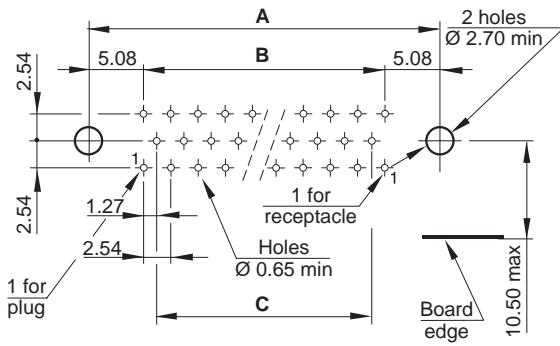

Female or male, plug or receptacle, 90° termination
Guide styles: 124 - 133

No. of contacts	26	44	62	80	98	144	162
A	30.48	45.72	60.96	76.20	91.44	137.16	152.40
B	20.32	35.56	50.80	66.04	81.28	58.42	66.04
C	17.78	33.02	48.26	63.50	78.74	-	-

► BOARD PREPARATION DETAILS

ONE PART (moulding A)

DAUGHTER BOARD

26 TO 98 CONTACTS

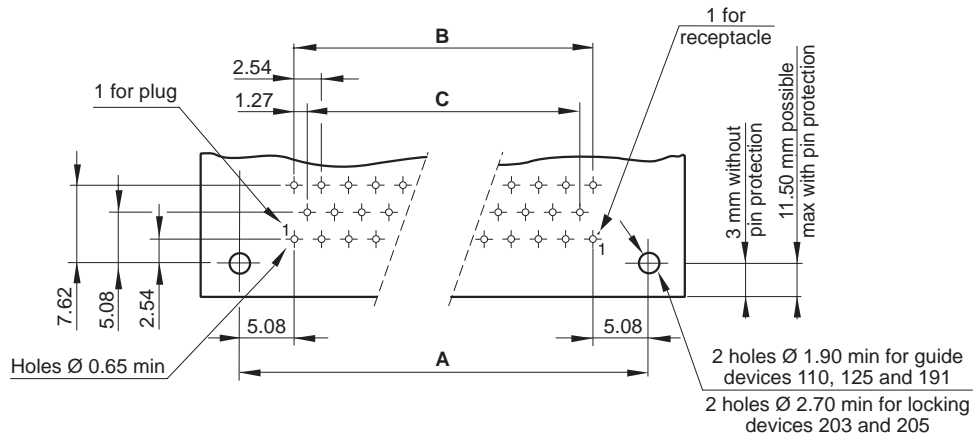

Male, plug or receptacle, 90° termination
Guide styles: 110 - 125 - 191 - 203 - 205

144 TO 162 CONTACTS

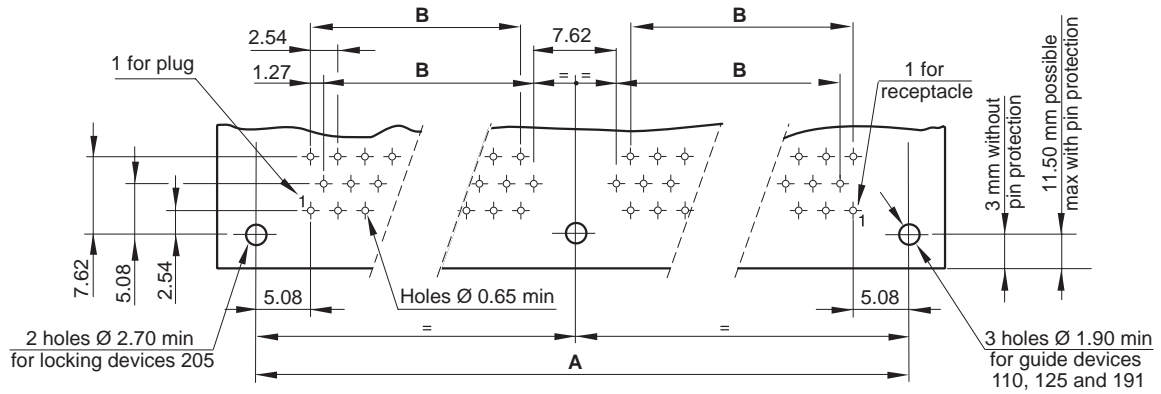

Male, plug or receptacle, 90° termination
Guide styles: 110 - 125 - 191 - 205

No. of contacts	26	44	62	80	98	144	162
A	30.48	45.72	60.96	76.20	91.44	137.16	152.40
B	20.32	35.56	50.80	66.04	81.28	58.42	66.04
C	17.78	33.02	48.26	63.50	78.74	-	-

▶ BOARD PREPARATION DETAILS

ONE PART (moulding A)

DAUGHTER BOARD

144 TO 162 CONTACTS

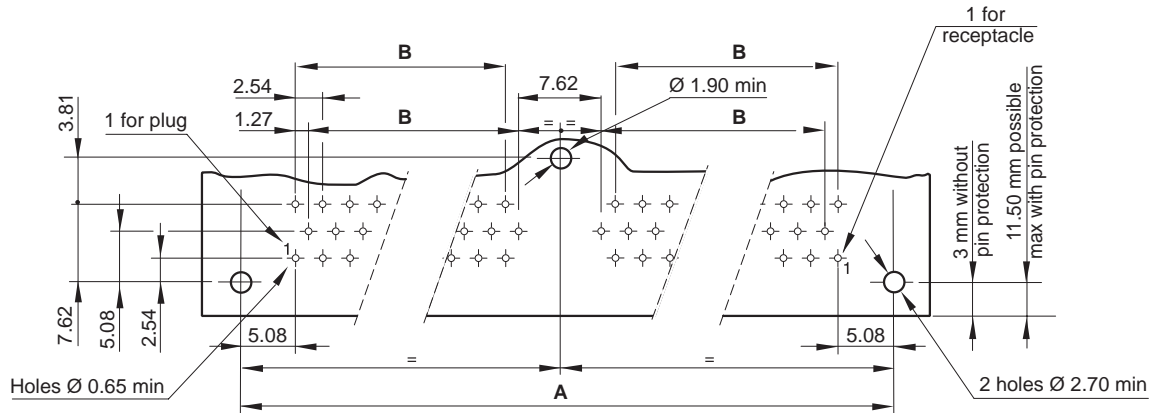

Male, plug or receptacle, 90° termination
Locking styles: 203

No. of contacts	26	44	62	80	98	144	162
A	30.48	45.72	60.96	76.20	91.44	137.16	152.40
B	20.32	35.56	50.80	66.04	81.28	58.42	66.04
C	17.78	33.02	48.26	63.50	78.74	-	-

▶ PANEL PREPARATION DETAILS

TWO PARTS (moulding B)

26 TO 98 CONTACTS

144 TO 162 CONTACTS

MOTHER BOARD

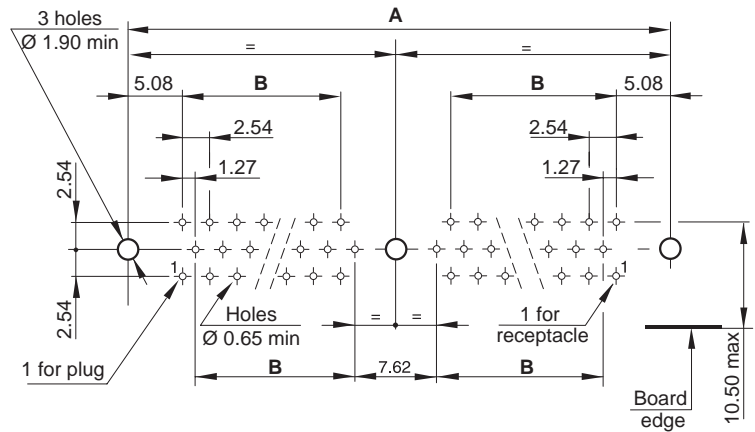
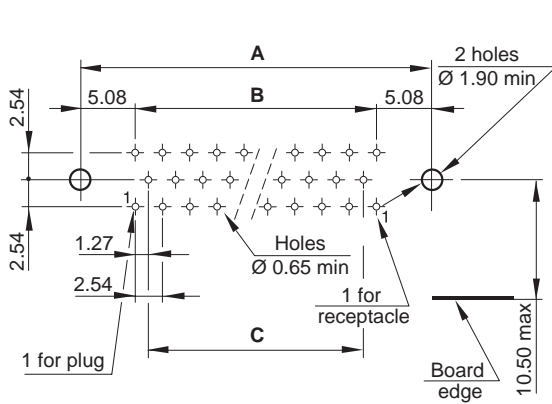

Plug or receptacle, 90° termination
Guide styles: 153 - 154 - 155 - 156

DAUGHTER BOARD

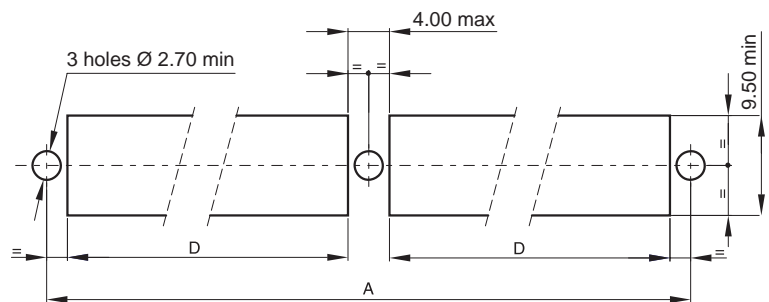
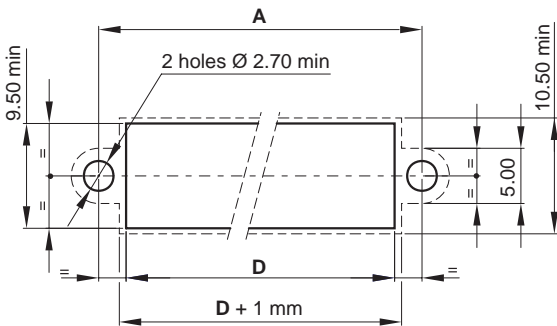

— Fixed mount - - - Float mount (2 mm thickness)

Female or male, plug or receptacle, 90° termination 40 - 50 - 51
Guide styles: 111 - 112 - 121 - 127 - 130 - 143 - 190 - (Fixed Mount)
Guide styles: 113 - 123 - 128 - (Float Mount)
Locking Styles: 202 - 207

No. of contacts	26	44	62	80	98	144	162
A	30.48	45.72	60.96	76.20	91.44	137.16	152.40
B	20.32	35.56	50.80	66.04	81.28	58.42	66.04
C	17.78	33.02	48.26	63.50	78.74	-	-
D	25.90	41.20	56.40	71.60	86.90	63.60	71.60



SMITHS CONNECTORS GLOBAL SUPPORT

AMERICAS

info.us@smithsconnectors.com

Costa Mesa, CA
1.714.371.1100

Hudson, MA
1.978.568.0451

Kansas City, KS
1.913.342.5544

EUROPE

France

33.2.32969176
info.fr@smithsconnectors.com

Germany

49.991.250.120
info.de@smithsconnectors.com

Italy

39.010.60361
info.it@smithsconnectors.com

United Kingdom

44.208.236.2400
info.uk@smithsconnectors.com

ASIA

asiainfo@smithsconnectors.com

Shanghai, China
86.21.3318.4650

Suzhou, China
86.512.6273.1188

Singapore
65.6846.1655

visit us at | smithsconnectors.com |     